

OUTERIMPACT

SMITH & WESSON® M&P- M.R.A. (Modular RedDot Adapter) Mounting Instructions

Utilize a certified Gun Smith to install adapter. It is possible to install adapter if a Gun Smith is not accessible, but it is recommended that adapter be installed by a Gun Smith.

WARNING: *Never remove or install components on a gun before ensuring the gun is not loaded and the chamber is clear.*

STEP 1: Install Outerimpact Dovetail onto slide.

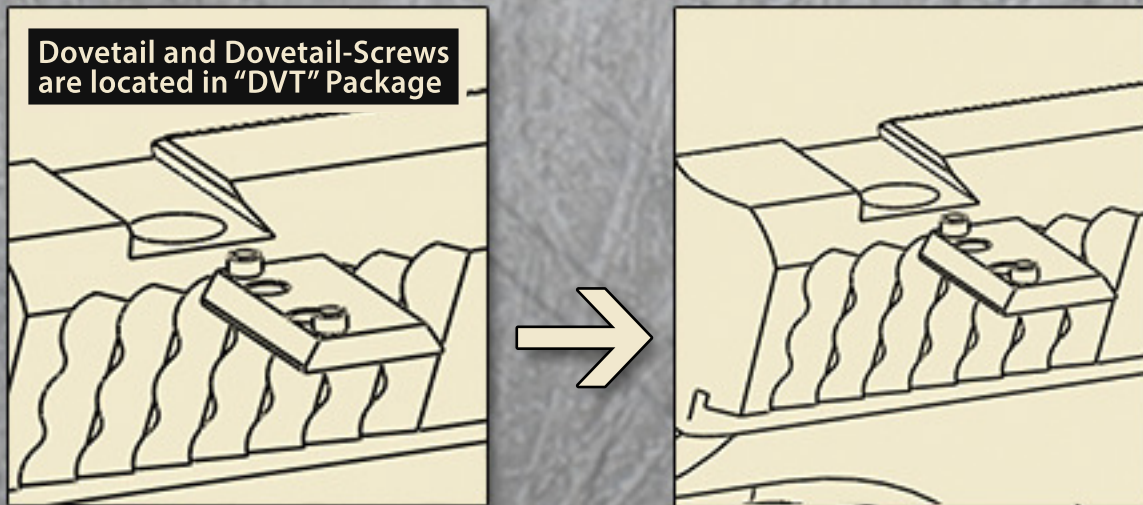



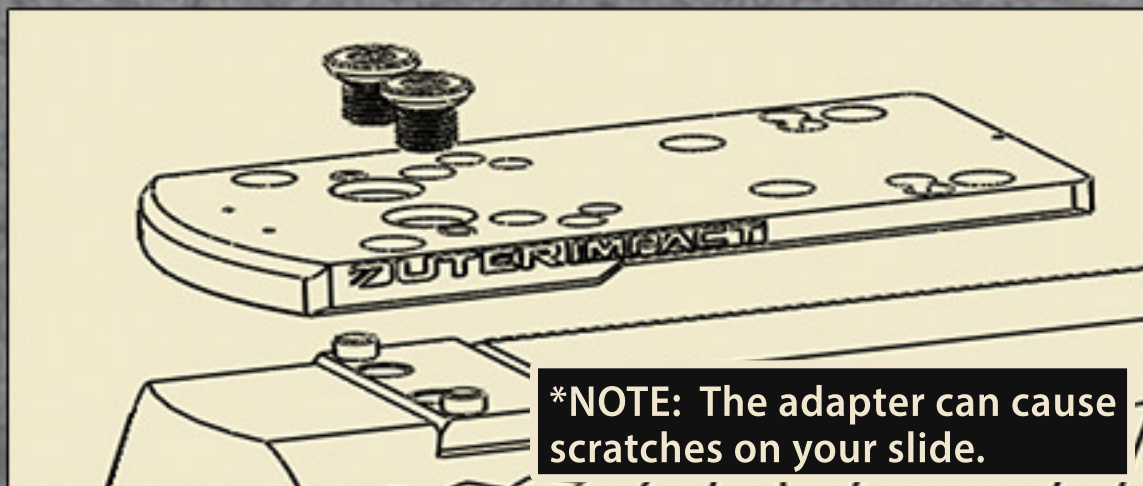

STEP 2: Test fit the Red Dot sight to Outerimpact adapter, utilizing Red Dot Adapter Chart. Note: make sure screws do not stick out beyond bottom of adapter. After test fitting remove Red Dot sight from adapter.

STEP 3: Secure sight adapter to dovetail with supplied weaver screws. Torque to 25 in/lbs

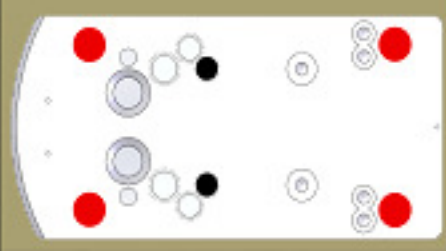

NOTE: THE ADAPTER BASE PLATE HAS AN INTENTIONAL CURVE. THIS CURVE WILL FLATTEN OUT WHEN MOUNTED TO THE FIREARM.

STEP 4: Using the Screws/Pins and mounting pattern identified in Step 3, mount the Red Dot sight to the adapter and torque to 12in/lbs

MOUNTING PATTERNS:	SIGHT Manufacture	SIGHTS Model	SCREWS USED
The RED circles indicate locations for 2 included alignment pins  The BLACK circles indicate locations for mounting screws ---- Torque Screws to 12 IN/LBS			
	VORTEX BURRIS	VIPER FAST FIRE 3	M3 x 8mm 
	BURRIS DOCTOR INSIGHT EOTECH	FAST FIRE 2 MRDS MRDS	M3 x 6mm 
	VORTEX	VENOM	M3 X 6mm 

	TRIJICON			#6 SCREWS 
	RMR			

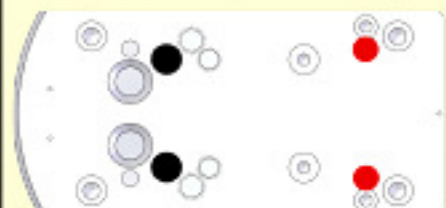
	LEUPOLD			SIGHT SUPPLIED SCREWS WORK
	Delta Point Delta Point Pro			

	VORTEX	RAZOR	M4 SCREWS 
	SIG SAUER	ROMEO3	
	CMORE	RTS & STS	

UTILIZE LIQUID THREAD LOCKER UPON FINAL INSTALLATION OF ALL THREADED FASTENERS.